



# Oasis®

## Instant start site welfare solutions

- **EcoLogic** range
- **EcoMax** range
- **WelGen** range
- **Vision** range



Oasis is only available from **Advanté**



Our Oasis EcoLogic range offers the latest thinking in providing 'green' instant start welfare for your site. With increased emphasis on continued reduction of your site's Carbon Footprint, our EcoLogic range will not only significantly reduce your Carbon emissions, but also cut down on your running cost.

### EcoLogic 1850

An increasing number of sites are now required to include shower facilities as part of their welfare. Our EcoLogic 1850 provides a complete site set-up with office, canteen, drying room, 2 toilets and a shower.

### EcoLogic 1750

If you are looking for a complete site set-up which caters for 25 people in one unit, then look no further than our EcoLogic 1750; this unit provides quality welfare for your staff at a low Carbon Footprint per person and includes an office, canteen, drying room and 2 toilets.

### EcoLogic 1700

If you need a large, flexible self-contained space on your site, our EcoLogic 1700 is the solution. It provides an open plan area, large enough for 3 desks, which alternatively can be used as a meeting room. The unit also has kitchen facilities, a drying room and 2 toilets.

### EcoLogic 1400

If you need to provide canteen space for larger numbers of staff, our EcoLogic 1400 has seating for 16 people in one sitting. In addition the unit also has a drying room and 2 toilets.

### EcoLogic 800

If you are looking for the benefits of our EcoLogic range, but don't have room on site for a 32ft unit, then the EcoLogic 800 is the answer, as this unit provides an office, canteen, drying room and toilet in a 24ft unit.

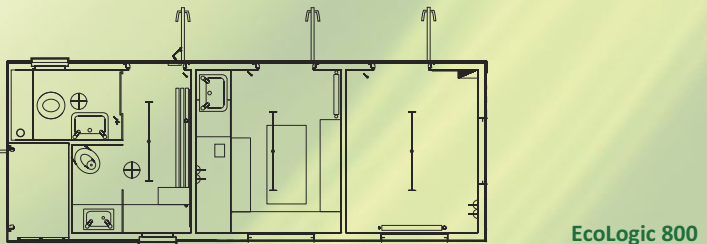
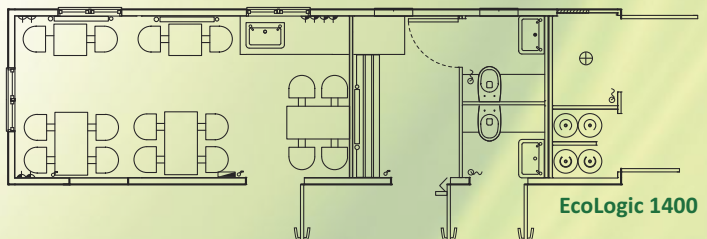
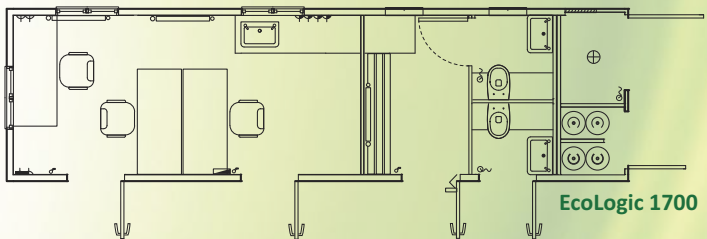
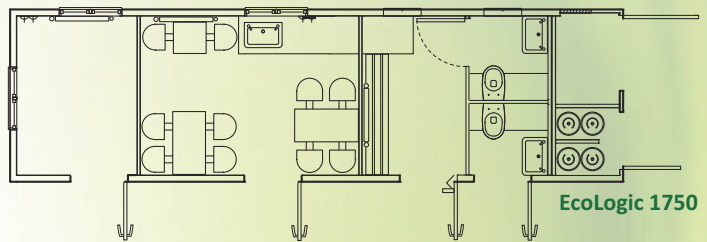
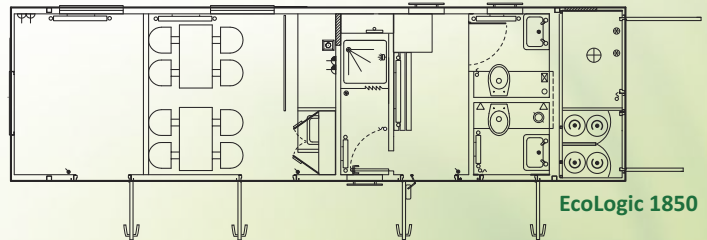

Today's sites have a need for more office and welfare space from day one, while taking up the lowest possible footprint.



EcoMax is the solution! Relocation of the EcoMax set-up is easy, giving total flexibility of build programme.

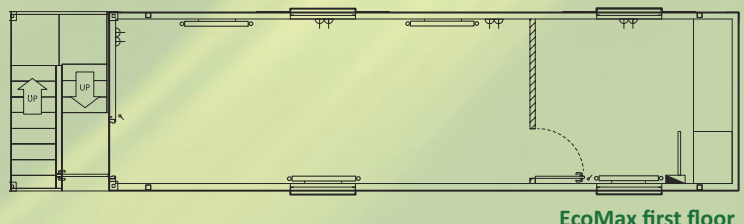

The above plan shows the first floor EcoMax office, the ground floor can be tailored to your needs using any of the 32' EcoLogic layouts.

# WelGen range

Within our WelGen range you have a choice of a wide range of layouts and sizes allowing you to choose the unit exactly matching your site's requirements. All WelGen units cater for up to 15 site staff and layout options available include units with office, shower or store.

## WelGen 850

If you need to provide shower facilities as part of your welfare, our WelGen 850 provides a complete site set-up, including office, canteen, drying room, toilet and shower. This unit ticks a lot of the boxes for Considerate Constructors!

## WelGen 800

Our WelGen 800 is the model to consider if, in addition to providing you with a full site set-up combining office, canteen, drying room and toilet in one 24ft unit, you are also interested in showing your company's green credentials with double glazing and waste water recycling.

## WelGen 800 Solar

Our WelGen 800 Solar gives all the benefits of the WelGen 800 with the addition of solar power.

## WelGen 750

Our most popular model, a complete site set-up of office, canteen, drying room and toilet in one 24ft unit, meeting all your Health & Safety requirements.

## WelGen 700

If you need a large, flexible self-contained space on site – look no further than our WelGen 700. The unit is equally suitably to be used as a meeting room or office large enough for 2 desks.

## WelGen 500

In addition to providing your site with full welfare facilities of canteen, drying room and toilet, the WelGen 500 also contains a built-in store.

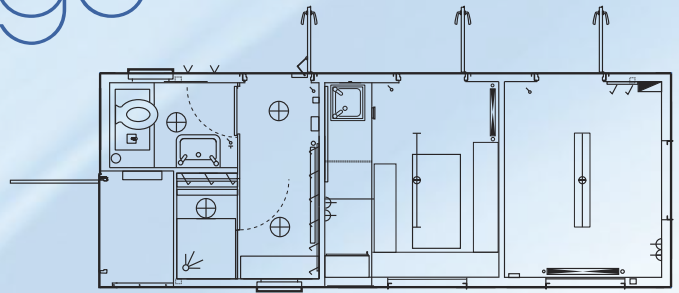

WelGen 850

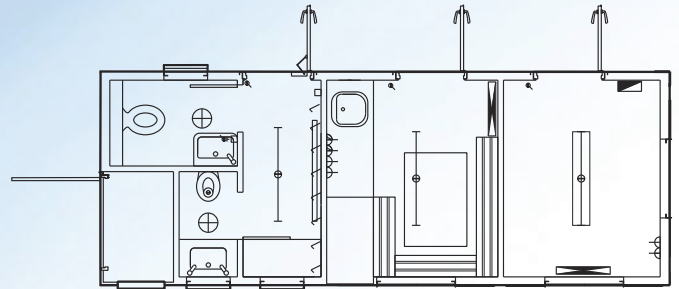

WelGen 800 & 800 Solar

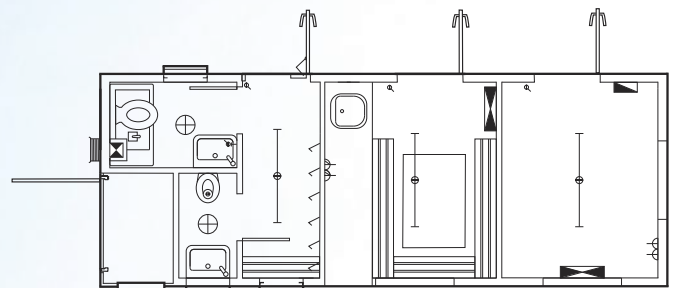

WelGen 750

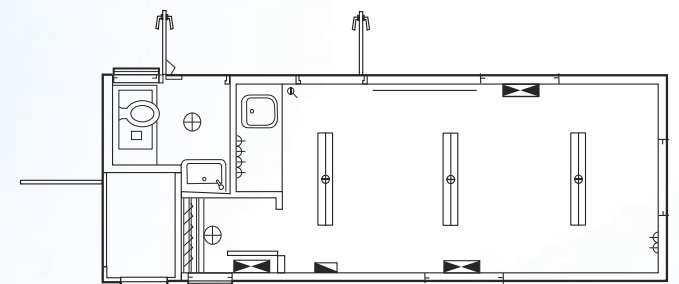

WelGen 700

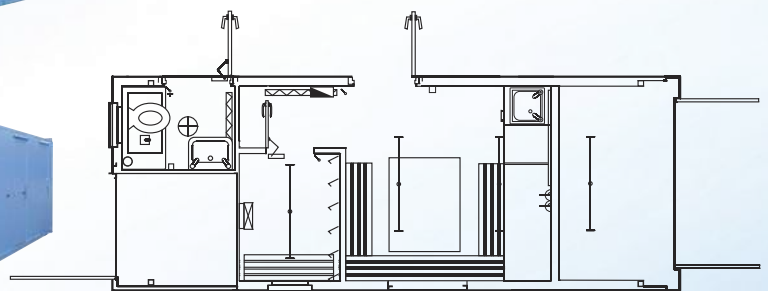

WelGen 500



WelGen 850, 800 & 800 Solar



WelGen 750



WelGen 700



WelGen 500

# WelGenrange continued

## WelGen 400

Our WelGen 400 with seating for 12 people is the ideal unit when providing canteen facilities for larger numbers of staff in one sitting.

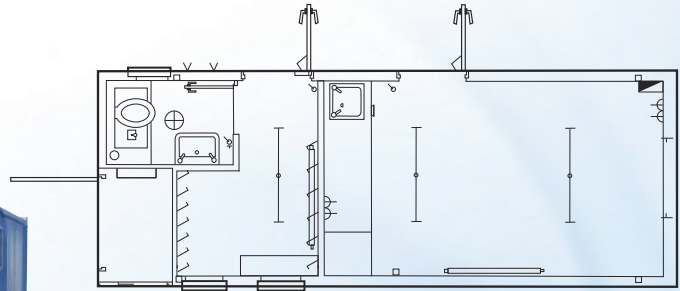

WelGen 400

## WelGen 250

With its 16x9ft footprint, the WelGen 250 is aimed at supplying welfare facilities when space is limited.

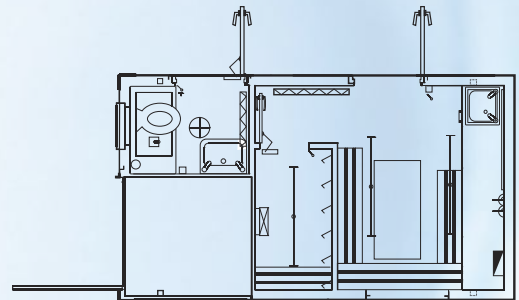

WelGen 250

# Visionrange

## Need an instant start toilet block?

Look no further than our Vision range of 2+1 self-contained toilet blocks complete with integral water and effluent tanks.

## Vision 11 (2+1)

The Vision 11 (2+1) is a diesel generator powered, self-contained toilet unit, giving you toilet facilities from the moment it is delivered to site.

## Vision 19 (2+1)

The Vision 19 has the same layout as the Vision 11, with the added benefit of a larger (19kva) generator, enabling you to utilise the generator from this toilet block to power another standard unit.



Vision 11 (2+1)  
Vision 19 (2+1)

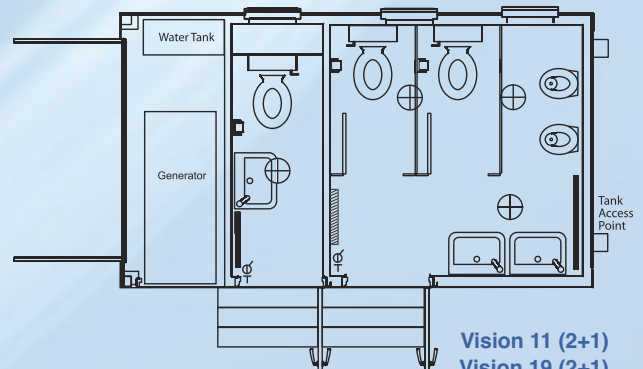

Vision 11 (2+1)  
Vision 19 (2+1)

# Oasis model range



Model	Size	Office	Canteen	Drying Room	Toilet	Shower	Store
EcoLogic 1850	32x9	✓ 1 desk	✓ 8 seats	✓	✓ 2 toilets	✓	
EcoLogic 1750	32x9	✓ 1 desk	✓ 10 seats	✓	✓ 2 toilets		
EcoLogic 1700	32x9	✓ 3 desks	kitchen facilities	✓	✓ 2 toilets		
EcoLogic 1400	32x9		✓ 16 seats	✓	✓ 2 toilets		
EcoLogic 800	24x9	✓	✓	✓	✓		



Model	Size	Office	Canteen	Drying Room	Toilet	Shower	Store
<b>FIRST FLOOR:</b>							
Separate manager's office & large open plan office/meeting room	32x9	✓					
<b>GROUND FLOOR:</b>							
Option 1: EcoMax 1850	32x9	✓ 1 desk	✓ 8 seats	✓	✓ 2 toilets	✓	
Option 2: EcoMax 1750	32x9	✓ 1 desk	✓ 10 seats	✓	✓ 2 toilets		
Option 3: EcoMax 1700	32x9	✓ 3 desks	kitchen facilities	✓	✓ 2 toilets		
Option 4: EcoMax 1400	32x9		✓ 16 seats	✓	✓ 2 toilets		

## WelGen

Model	Size	Office	Canteen	Drying Room	Toilet	Shower	Store
WelGen 850	24x9	✓	✓	✓	✓	✓	
WelGen 800 Solar	24x9	✓	✓	✓	✓		
WelGen 800	24x9	✓	✓	✓	✓		
WelGen 750	24x9	✓	✓	✓	✓		
WelGen 700	24x9	✓ 2 desks	✓	✓	✓		
WelGen 500	24x9		✓	✓	✓		✓
WelGen 400	24x9		✓	✓	✓		
WelGen 250	16x9		✓	✓	✓		

## Vision

Model	Size	Instant Start 2+1 Toilet Block
Vision11(2+1) & Vision19(2+1)	18x9	✓ 3 toilets

# Oasiswelfare

ticks all the boxes

## ✓ Service

- **Nationwide Next Day Delivery.**
- Client support team – **servicing your individual requirements.**
- Dedicated Account Handler – one point of contact.

## ✓ Health & Safety

- **Fully HSE Compliant.**
- **Full welfare facilities in all Oasis models, some units also include office, store or a shower.**

## ✓ Green

- Powered by LPG generators, which means a reduction in your Carbon Footprint when compared to diesel generators.
- EcoMax, EcoLogic and WelGen ranges provide your site with 'green' welfare.
- **Solar Power** incorporated on selected models.

## ✓ Reliable

- All Oasis units are subject to our rigorous quality check procedure prior to despatch to your site.
- Peace of mind - BSI Registered for OHSAS18001 (**Safety**), ISO14001 (**Environmental**) and ISO9001 (**Quality**).
- Our **telemetry** system allows us to identify and react to potential problems before they actually occur.

## ✓ Cost effective

- The Oasis units are powered using single fuel, dual power technology which saves your site up to **40%** in gas consumption.
- The generators within the Oasis units are closely matched to the unit demand meaning there is **no wasted energy or fuel.**

